

PROFYLE FLAT 5/15 - FLAT 5/15 RA

UNDER SCREED ACOUSTIC INSULATION



DECOUPLING ELEMENT MADE OF ADHESIVE AND PRE-CUT POLYETHYLENE



■ TECHNICAL SPECIFICATION

PROFYLE FLAT 5/15: Acoustic Insulation strip available in rolls made of 6 mm thickness made of polyethylene grey colour, 22-25 kg/m³ density. It is flat with adhesive, pre-cut on the corner line in order to facilitate the strip bending . Base 5 cm, height 15 cm

PROFYLE FLAT 5/15 RA: acoustic Insulation strip available in rolls made of 6 mm thickness made of polyethylene grey colour, 22-25 kg/m³ density. It is flat with adhesive, pre-cut on the corner line in order to facilitate the strip bending . Base 5 cm, height 15 cm; equipped with a band made of polyethylene for the overlap of heating panels.

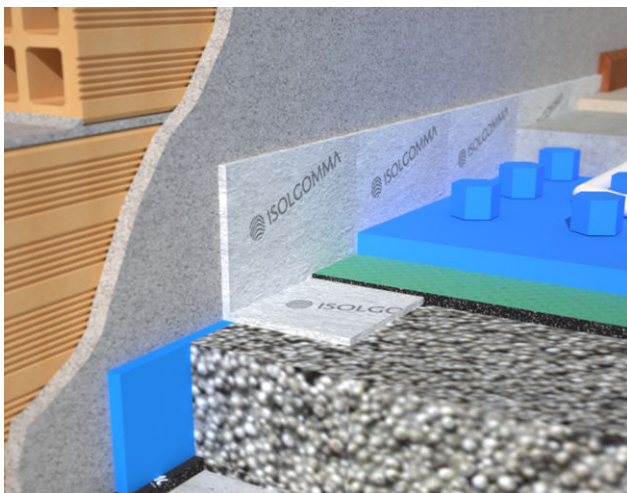

■ CERTIFIED ACOUSTIC IMPROVEMENT

Decoupling element essential to give insulation continuity and avoid acoustic bridges with walls

■ FLEXIBILITY

Made of pre-cut partially adhesive polyethylene, it can be used on both residential and commercial solutions

■ LAYING COSTS REDUCTION

The 50 m pre-cut strip allows a fast installation even in large environments with any interruption to insulation

■ TO BE USED WITH

Mandatory with under screed impact sound solutions and useful for screed/wall decoupling

■ TECHNICAL SPECIFICATION

Length (L)	50 m
Height (h)	150 mm
Width (b)	50 mm

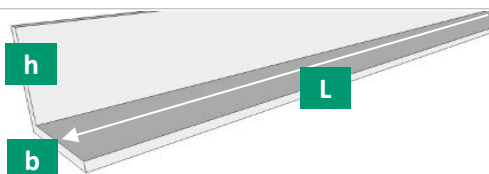

Thickness	6 mm
Dynamic stiffness s'	36 MN/m ³
Reaction to fire	F
Thermal conductivity coefficient λ	0,035 W/m K



PROFYLE FLAT 5/15 - FLAT 5/15 RA

UNDER SCREED ACOUSTIC INSULATION



INSTALLATION INSTRUCTIONS FOR PROFYLE FLAT

- 1** Clean the applying surfaces from dirty and sharp parts



- 2** Remove the protection film

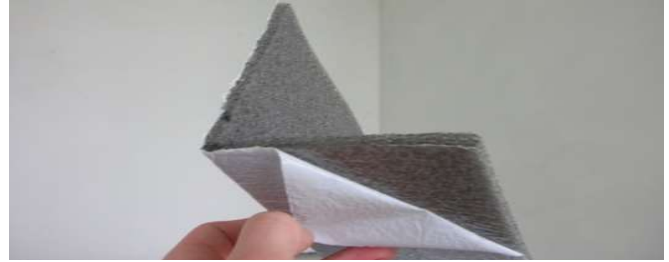

- 3** Glue the strip on both floor and wall surfaces by the external profile strip surfaces



- 4** Insulate the acute corners with the Profile strip by cutting it as shown in the drawing



- 5** Insulate the obtuse corners with the Profile strip by cutting it as shown in the drawing

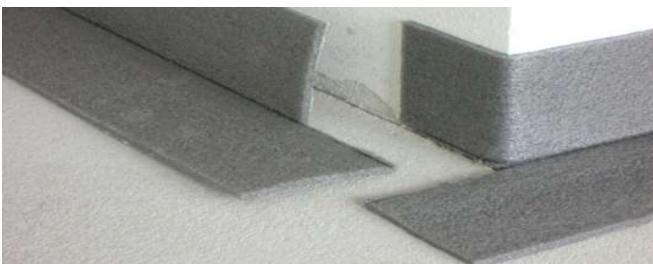

- 6** Apply the Profyle all along the walls room perimeter, as shown in the drawing

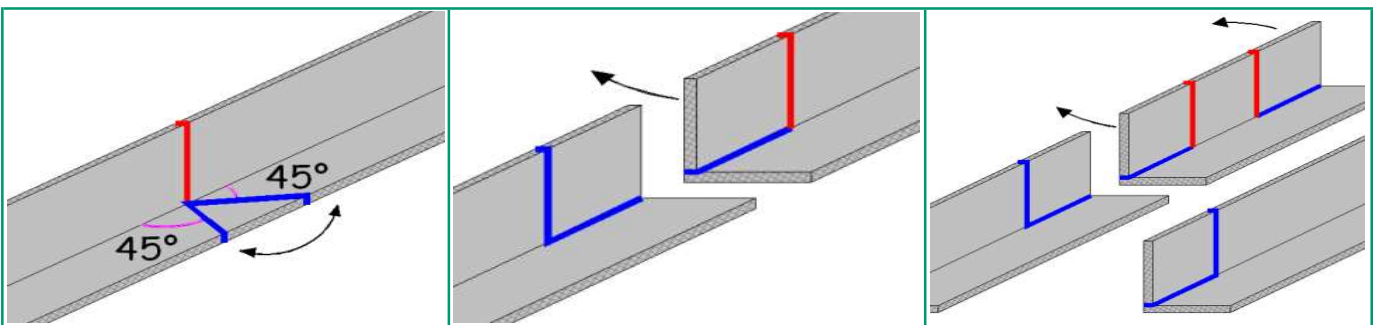

Cut along the blue line

Cut along the red line